

2010

on Site

“

Brian Sheldon

Partner SITE a/s

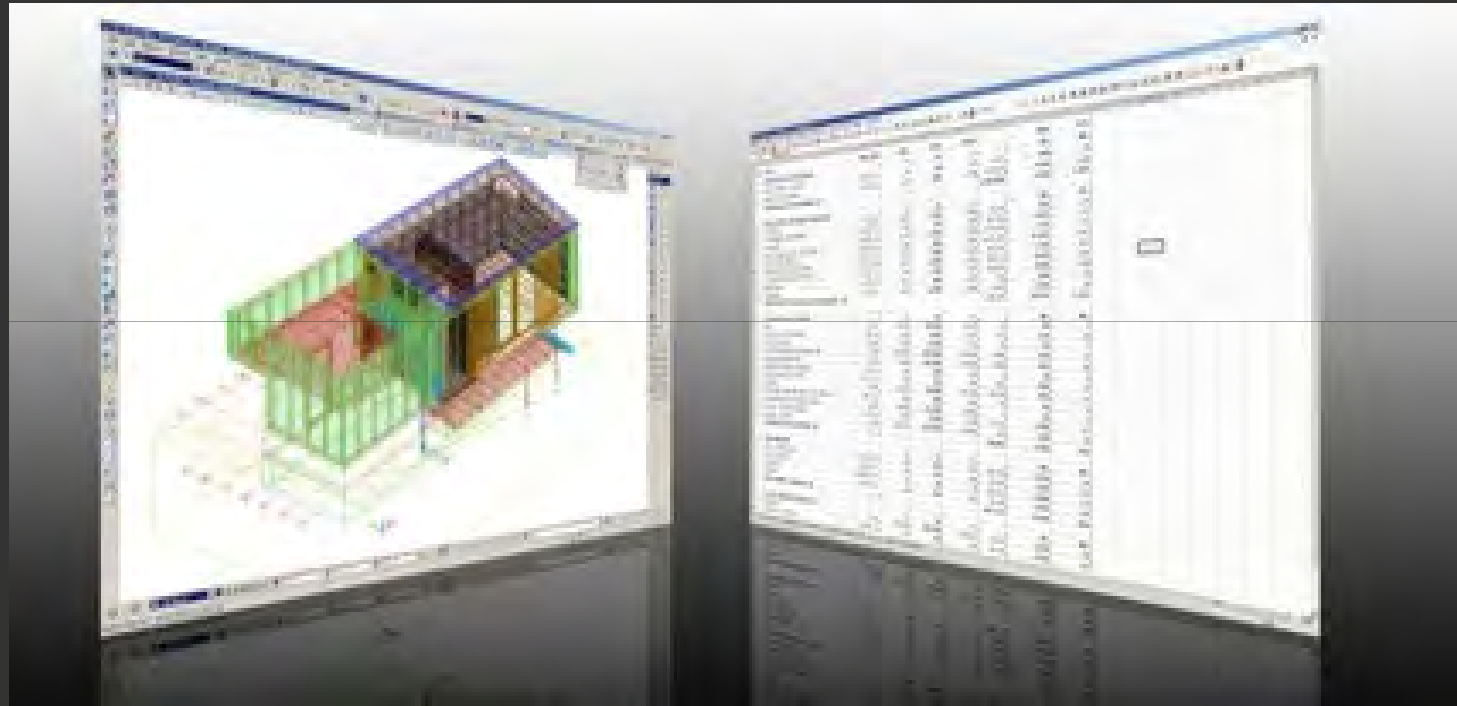

Bentleyuser.dk

Vejle 11.10.10

SITE A/S

BIM værdi

Projektudvikling

BIM

2010

on Site

“

Brian Sheldon

Partner SITE a/s

Part 1. POWERPOINT

- Hvad er BIM
- 3D CAD vs. BIM
- Hvem bruger BIM
- Hvad kan BIM bruges til
- BIM standarder

Part 2. LIVE

- PC Ballerup
- Spaces
- IFC

Bentleyuser.dk

Vejle 11.10.10

BIM værdi

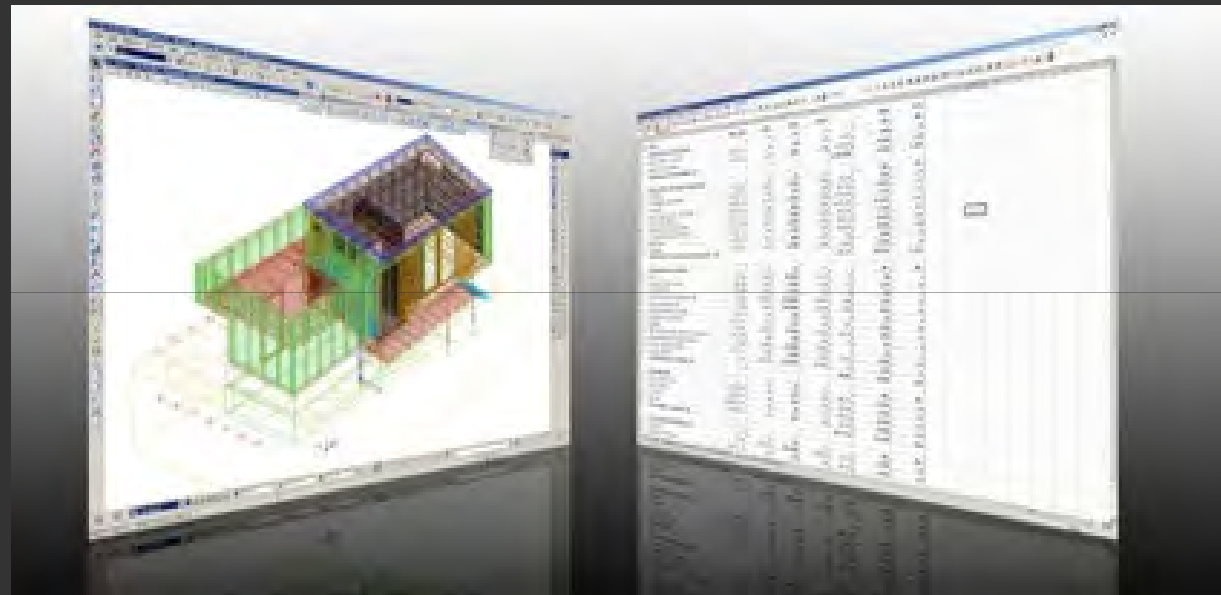

SITE A/S

BIM værdi

Projektudvikling

BIM

on Site

Method – the creative process

“

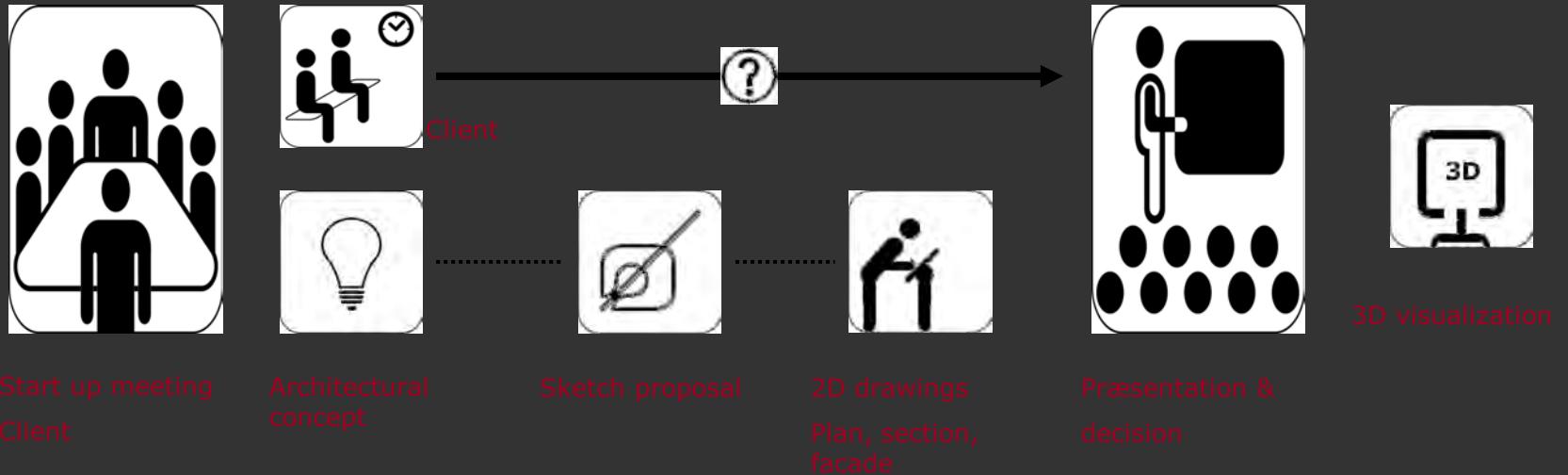

SITE

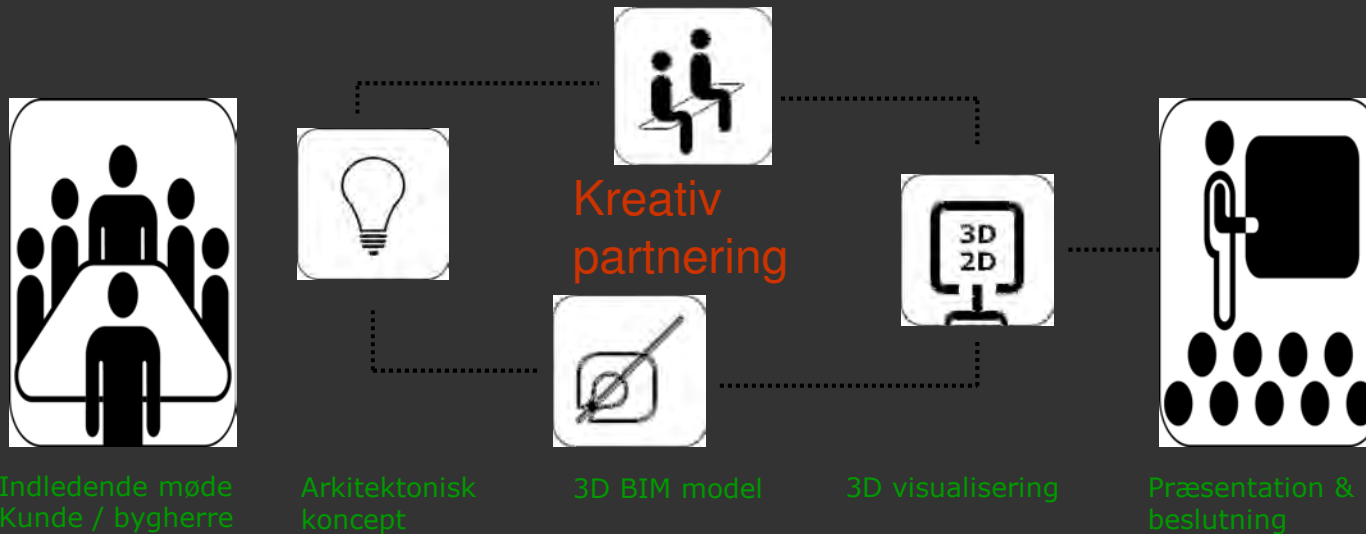

2010

Projektudvikling

on Site

“

3D skitseri

It is advantageous to sketch with 3D Cad software. Some of the benefits include: quickly visualising a series of alternatives, while maintaining an overview of m2, height, volume, and design. A sketch model can be

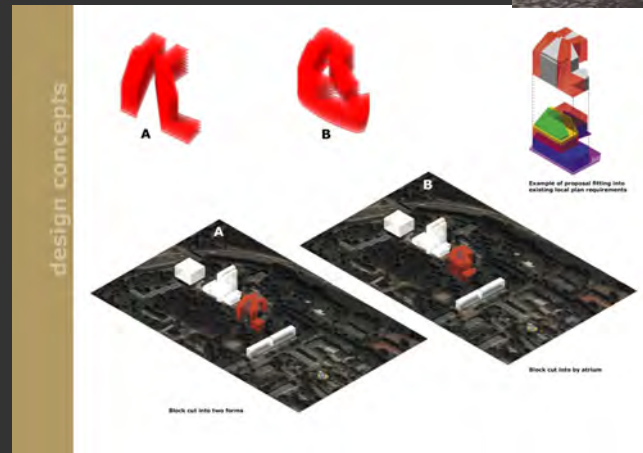
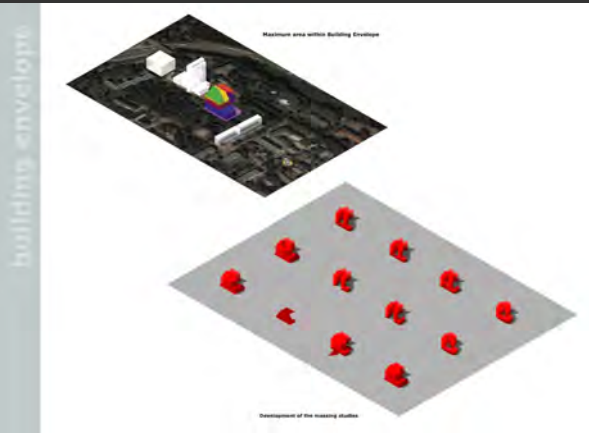

Case

on Site



Adobe Acrobat Document

Kregme Børnehave

SITE A/S

Værdikæde

Case

BIM Værdi



Dokumentation

traditional 2D drawings are generated or extracted, from the 3D model. The 3D model is constantly maintained which subsequently ensures that all drawing documentation is dynamicly updated.

Niras used Sites 3D BIM model to perform energy and light simulations to aid in the design process.

CASE:

Kregme Børnehave

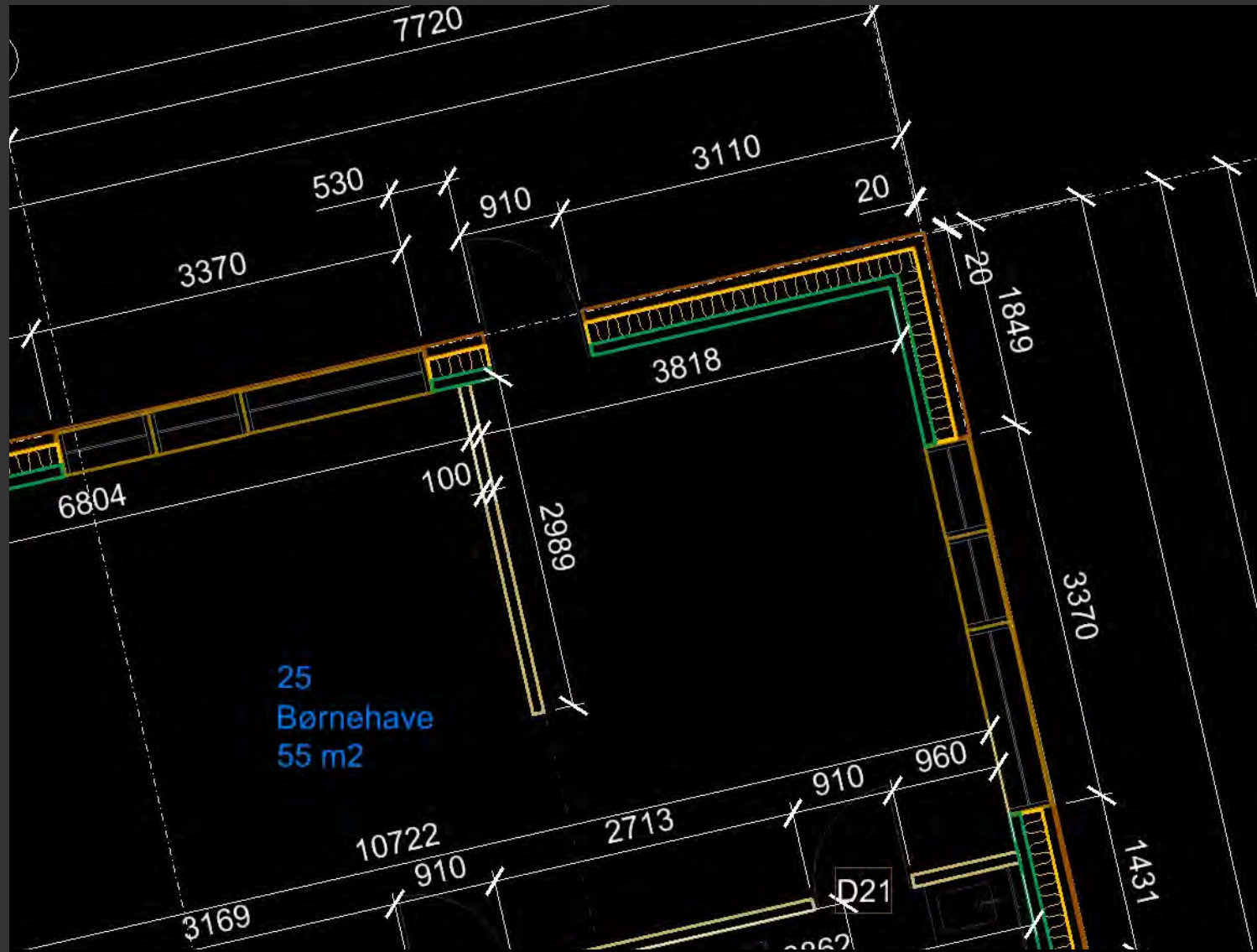

2010

on Site

BIM (Building Information Modeling)

“

Dokumentation

traditional 2D drawings are generated or extracted, from the 3D model. The 3D model is constantly maintained which subsequently ensures that all drawing documentation is dynamically updated.

Niras used Sites 3D BIM model to perform energy and light simulations to aid in the design process.

CASE:

Kregme Børnehave

on Site



Filudveksling og standarder

Behind the 2d and 3D geometry lies intelligent object data. Our dataset is currently based on BIPS 2005 /sfb. We translate our BIM data in IFC.

BIM object data

The screenshot displays the Revit software interface. The main window is the 'DataGroup Catalog Editor for 9005_1 Dong Energy (Catalog Items)'. It features a tree view on the left with categories like 'Areal', 'Beam: Concrete', 'Beam: Steel', 'Building', etc. The central pane shows a table of catalog items with columns for Definition, Property, Value, Editable, and Hidden. A dialog box titled 'Map custom Triforma dataset to IFC dataset' is open in the foreground, showing a mapping between 'Family-Part List' and 'IFC Entities'. The 'Mapped Entities' table at the bottom of the dialog is as follows:

Family	Part	IFC Entity
0_Area_010	*default space*	IfcSpace
0_Area_010	Administration	IfcSpace
0_Area_010	Atrium	IfcSpace
0_Area_010	Circulation (Horizontal)	IfcSpace
0_Area_010	Circulation (Vertical)	IfcSpace
0_Area_010	Kitchen	IfcSpace
0_Area_010	Lobby	IfcSpace
0_Area_010	Mechanical	IfcSpace
0_Area_010	Reception	IfcSpace
0_Area_010	Restrooms	IfcSpace

SITE A/S

værdikæde

Case

BIM værdi

on Site

“

Successive price calculations

SITE has developed an optimised price calculation tool together with Denmark's Teknologisk institute. We use IFC data from our BIM model and import it directly into SIGMA Bim data is keyed to standard and project specific price databases to calculate on the fly successive price calculations.

IFC

Opdater fra bibliotek

Opdatering af komponenter fra bibliotek eller prisliste

Denne guide anvendes til matche komponenter i projektet med komponenter i f.eks. et pris-bibliotek. Bemærk at komponenter matches på nummer kolonnen.

Vælg type:

Bibliotek:

Indstillinger

Følgende felter beholdes fra oprindelig komponent. Alle øvrige felter overskrives med værdien fra bibliotek.

Skal også gælde for under-komponenter

Kør opskrifter for udskiftede komponenter (dette kan tage lang tid)

Position	Nr	Tekst	*	Kategori	Enhed	Mængde	Enhedspris	Kostpris	Samlet EP	Samlet KP	Regul.
								9.169.825,53		8.223.401,13	
1.1	--22	Diverse		CAD	m2	465,1251	0,00	0,00	0,00	0,00	1,000
1.2	--AB11	Hygiejne og personlig pleje af typen Badeværelser / baderum		CAD	m2	78,7227	9.997,28	787.012,85	12.196,68	960.155,68	1,220
1.3	--AB22	Pasning og omsorg af typen Børnehaverum		CAD	m2	219,2715	9.997,28	2.192.118,77	7.797,88	1.709.852,64	0,780
1.4	--AB28	Opbevaring og lagring af typen Depoter		CAD	m2	27,281	9.997,28	272.735,79	7.797,88	212.733,91	0,780
1.5	--AB30	Adgang, modtagelse og fordeling af typen Vindfang		CAD	m2	11,8307	9.997,28	118.274,94	7.797,88	92.254,45	0,780
1.6	--AC11	Hygiejne og personlig pleje af typen Handicaptoiletter		CAD	m2	4,4586	9.997,28	44.574,34	12.196,68	54.380,70	1,220
1.7	--B22	Pasning og omsorg af typen Omsorgsrum		CAD	m2	50,2652	9.997,28	502.515,54	7.797,88	391.962,12	0,780
1.8	--BA15	Serivering og indtagelse af mad af typen Kantinerum		CAD	m2	23,1213	9.997,28	231.150,51	12.196,68	282.003,62	1,220
1.9	--BA30	Adgang, modtagelse og fordeling af typen Gange		CAD	m2	57,991	9.997,28	579.752,57	7.797,88	452.207,01	0,780
1.10	--BB14	Tilberedning og anretning af føde af typen Kantinekøkkenrum		CAD	m2	28,4182	9.997,28	284.104,65	12.196,68	346.607,68	1,220
1.11	--BC23	Industri og reparation af typen Malerværkstedrum		CAD	m2	29,2843	9.997,28	292.763,83	9.997,28	292.763,83	1,000
1.12	--BC28	Opbevaring og lagring af typen Bagagerum		CAD	m2	80,0874	9.997,28	800.656,56	7.797,88	624.512,12	0,780
1.13	--AA11	Hygiejne og personlig pleje af typen Toiletter / toiletrum / wc'er		CAD	m2	22,7025	9.997,28	226.963,17	12.196,68	276.895,07	1,220
1.14	--AA12	Tøjvask og -behandling af typen Vaskerum		CAD	m2	26,8829	9.997,28	268.756,11	12.196,68	327.882,45	1,220
1.15	--AA20	Møde og forsamling af typen Møderum		CAD	m2	74,1291	9.997,28	741.089,44	9.997,28	741.089,44	1,000
1.16	--AA22	Pasning og omsorg af typen Vuggestuerum		CAD	m2	167,8893	9.997,28	1.678.436,61	7.797,88	1.309.180,56	0,780
1.17	--AA26	Service, forvaltning og tjenesteydelse af typen Kontorer		CAD	m2	14,896	9.997,28	148.919,85	9.997,28	148.919,85	1,000
1.18	--AA70	Administration		CAD	m2	41,1822	0,00	0,00	0,00	0,00	1,000

SITE A/S

værdikæde

Case

BIM værdi

2010

on Site

Kommunikation

“

Mynd. godkend

The authorities in Borås Sweden were concerned about the visual impact of a 40.000m² shopping center in the city's historic center. A series of realistic images were generated from predefined vantage points to aid in the approval process..

CASE: **Wafveriet**

Borås, Sverige



Visual
a

Kommunikation

Projektudvikling

BIM

2010

on Site

“

Projekt godkendelse

Shadow diagrams provide an accurate picture of the effects of a proposed building mass. The results are a useful tool for client and building authorities to make qualified decisions.

Kommunikation



Navigation

Kommunikation

Projektudvikling

BIM

2010

on Site

Kommunikation

“

3D pdf

▪3d pdf is a quick and easily accessible interactive viewing tool.

Viewing models are created directly from the active working model, which guarantees an up to date and accurate document.



Adobe Acrobat
Document

CASE:

Køge Centrum

Volume study

Navigation

Kommunikation

Projektudvikling

BIM

2010

on Site

“

Animation

Animations are an effective way to explore the 3D model. The ambition level can vary according to the purpose of the presentation. Animations are produced directly from the working 3D model.



Kommunikation

SITE A/S

Værdikæde

Case

BIM værdi