

B5 – Context Capture

Erfaringer med Context Capture på mindre opgave



Intro

› Hvem er jeg?



Der skal bruges...









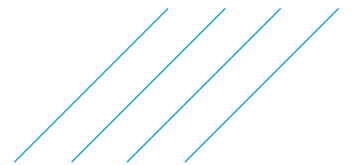

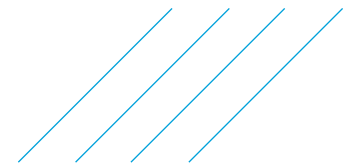

Input



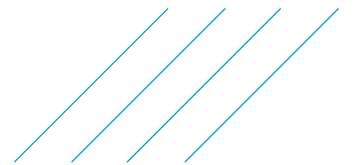

Output



Punktsky (LAS): 2,5 GB
Punktsky (POD): 1,1 GB
3D Scalable Mesh (3SM): **43 MB**



Udglatning (forenkling af rådata)





SNC • LAVALIN



SNC • LAVALIN





SNC • LAVALIN





SNC • LAVALIN



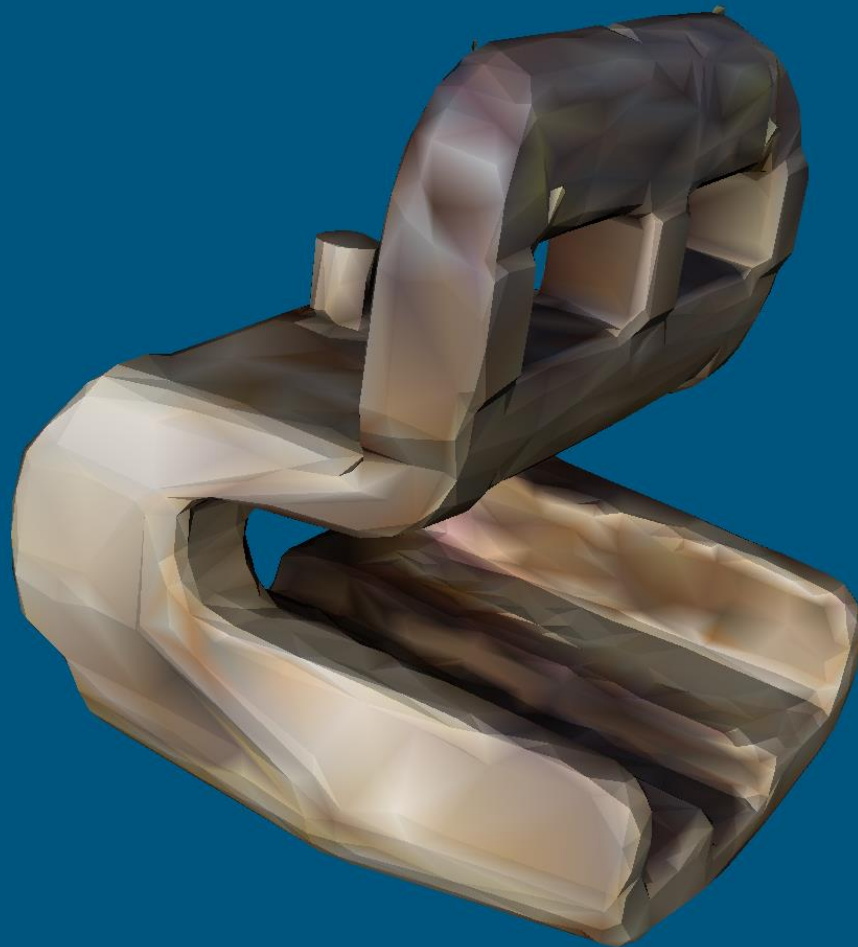

SNC • LAVALIN



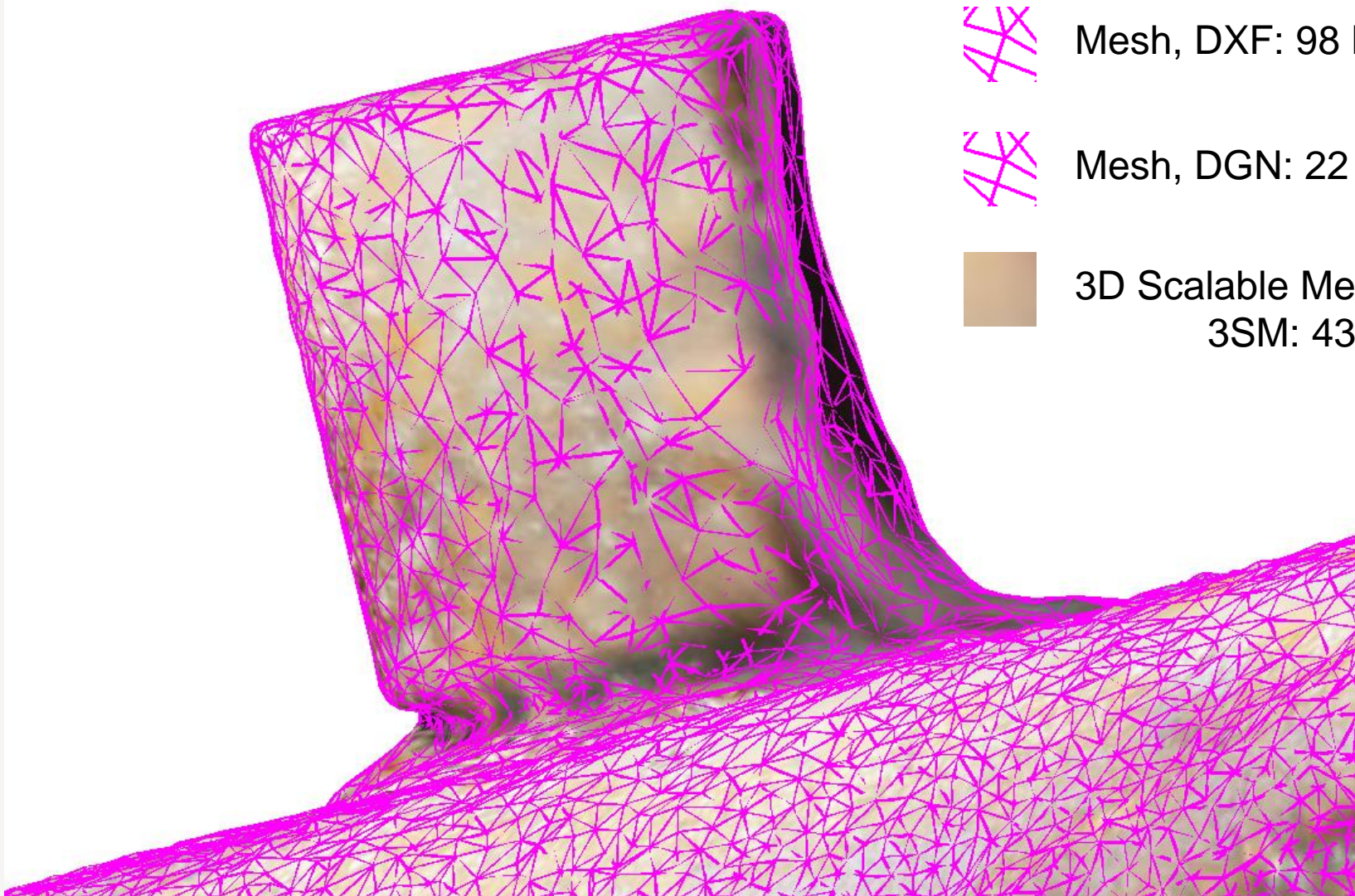

Mesh, DXF: 98 MB



Mesh, DGN: 22 MB



3D Scalable Mesh,
3SM: 43 MB



Mesh, Forenklet, DGN:
202 KB

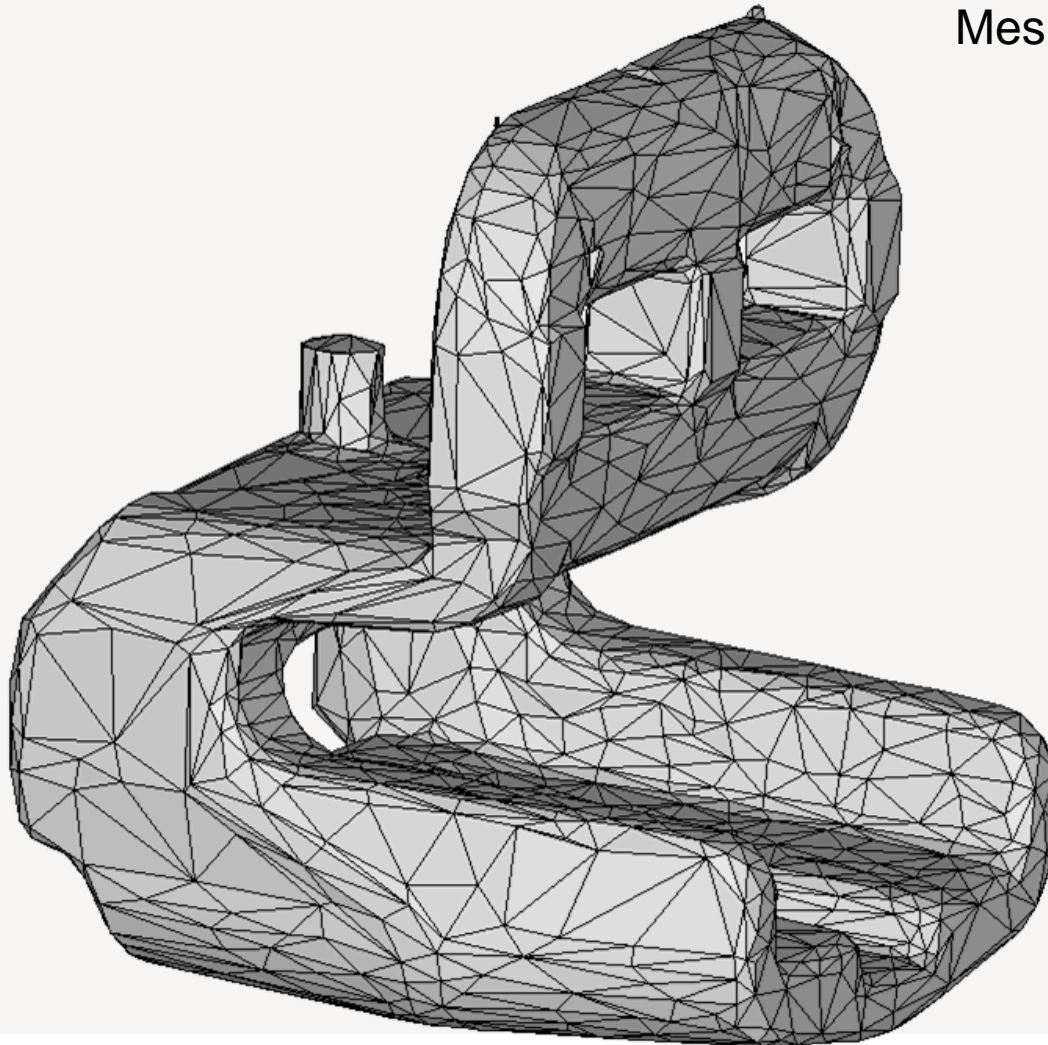

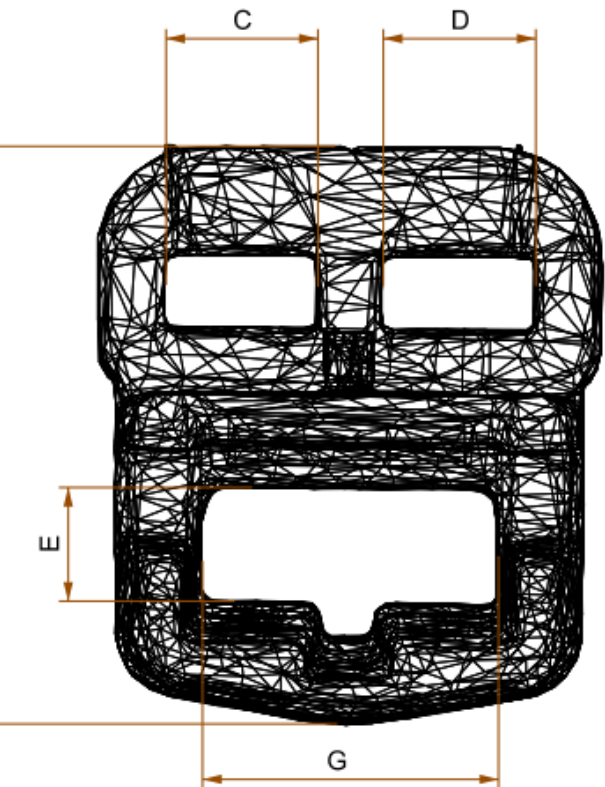
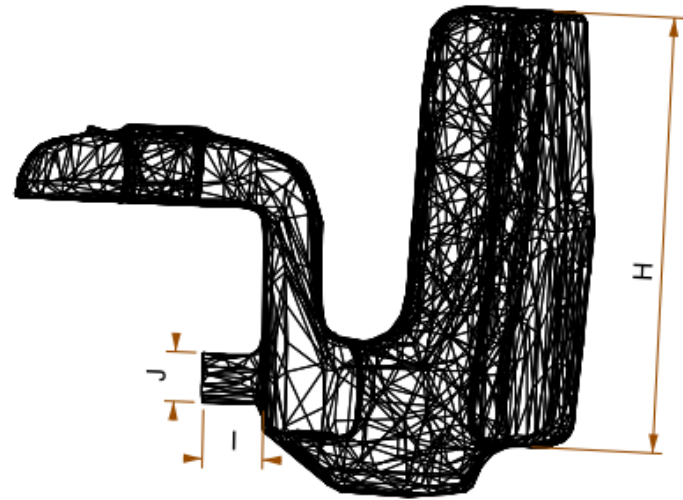
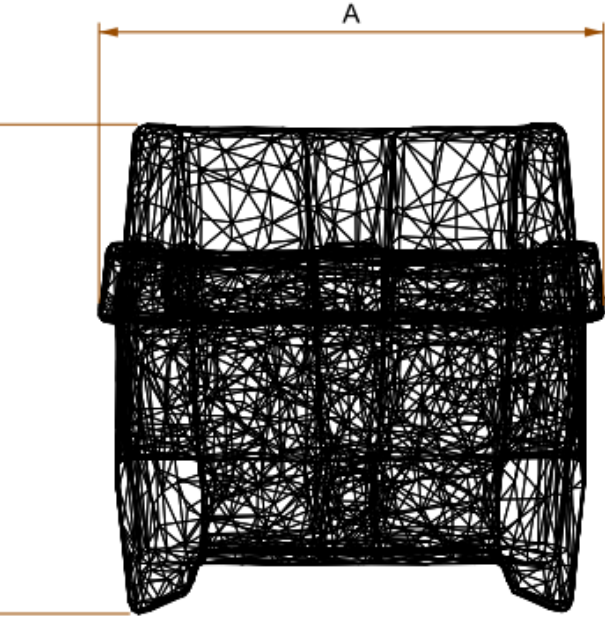

	Model:	Mål (rigtig):	Afvigelse:
A	186.40	186.50	0.054%
B	180.40	180.28	-0.067%
C	56.10	56.10	0.000%
D	56.30	56.40	0.177%
E	41.90	42.20	0.711%
F	213.10	212.53	-0.268%
G	109.30	109.60	0.274%
H	160.80	160.30	-0.312%
I	22.70	22.50	-0.889%
J	18.30	18.05	-1.385%

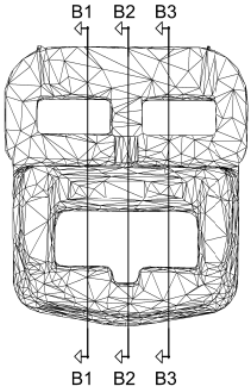
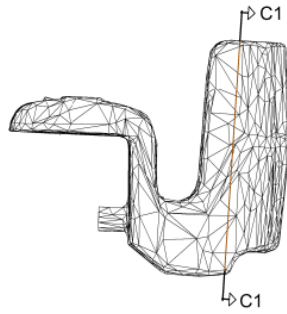
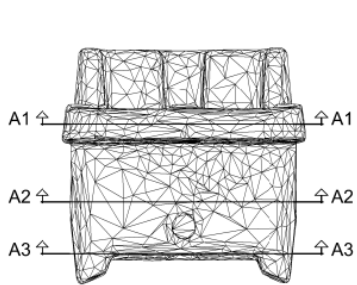

SNIT A1:

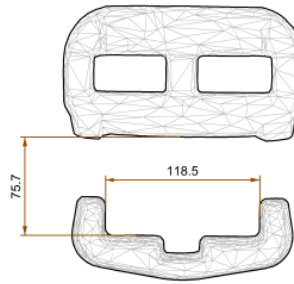

SNIT A2:

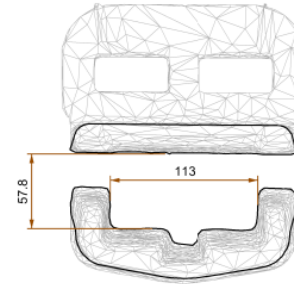

SNIT A3:

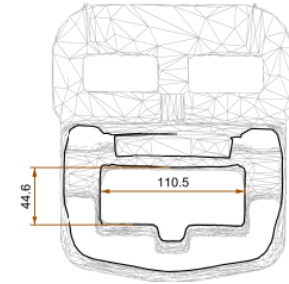

SNIT C1:

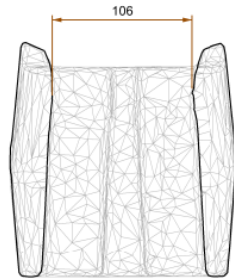

SNIT B1:

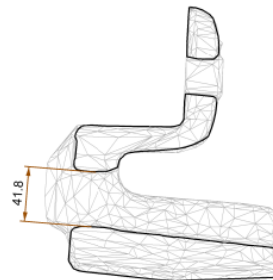

SNIT B2:

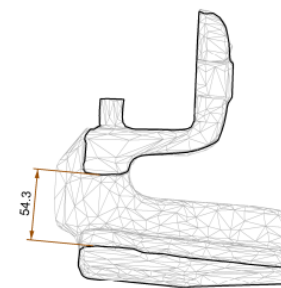

SNIT B3:

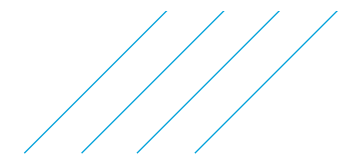
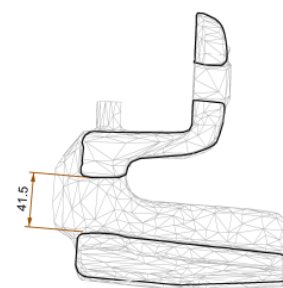

Live Demo



Spørgsmål?

