

Afsætnings data med -Open Roads



GEO
PARTNER

... i en større sammenhæng



Christian Nielsen
Kort- og landmålingstekniker

Christian Nielsen

Kontakt: Christian Nielsen – 21693613 – cni@geopartner.dk



Christian Nielsen
Kort- og landmålingstekniker

CHRISTIAN NIELSEN - 48ÅR

UDDANNET KORT & LANDMÅLINGSTEKNIKER I 1996

HAR BLA. ARBEJDET HOS:

2001-2011 AARSLEFF

– UDLAND, IMPLEMENTER MASKINSTYRING, HAVNE
BYGGERI, VEJBYGGERI

2011-2017 SITECH DANMARK

–DIREKTØR –SALG TRIMBLE TIL ENTREPRENØR

2017-2022 GEOPARTNER

– 3D DATA PRODUKTION, MASKINSTYRING, SCANNING,
JERNBANE

Afsætningsdata via ORD

- -Landmåleren anvender stadig punkter for afsætning af eks. kantsten i større eller mindre grad.
- -Hvis Entreprenør/Formanden selv skal afsætte, vil de fortrække punkter frem for 3D linjer.
- Derfor er funktionen stadig relevant i 2022.
- -Få indsigt i hvordan man ved hjælp af ORD's rapport funktioner
- 2D og 3D afsætningsdata er direkte importerbare i landmålingsudstyret.
- -Gennemgangen viser også fald grupperne

Data

- Giver også nogle udfordringer

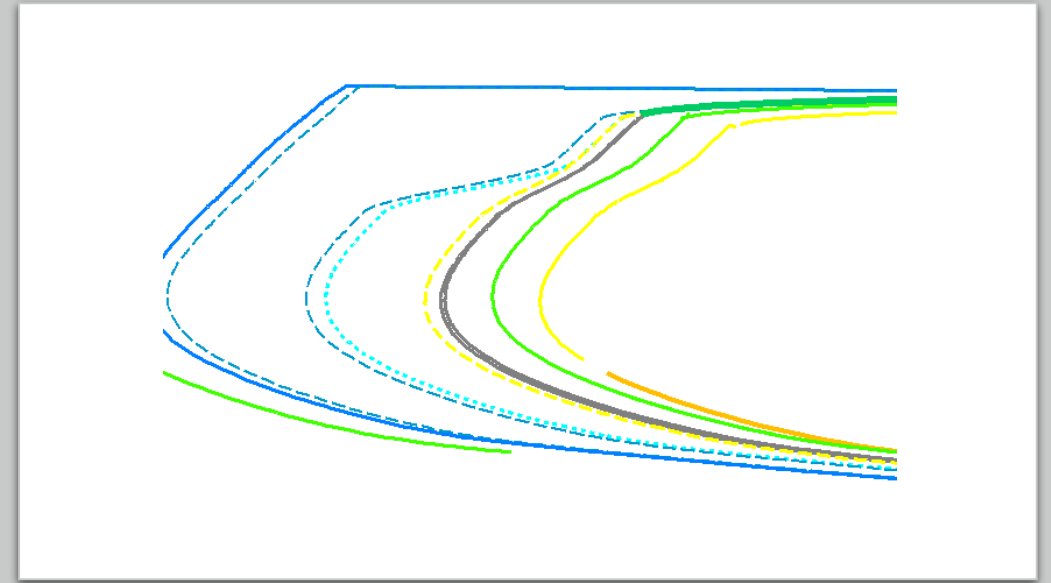
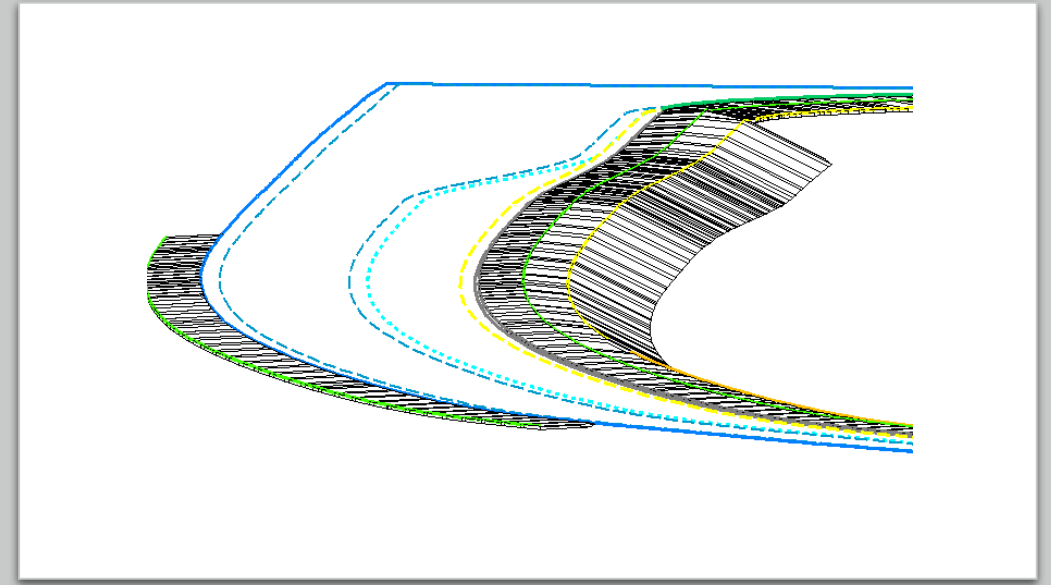
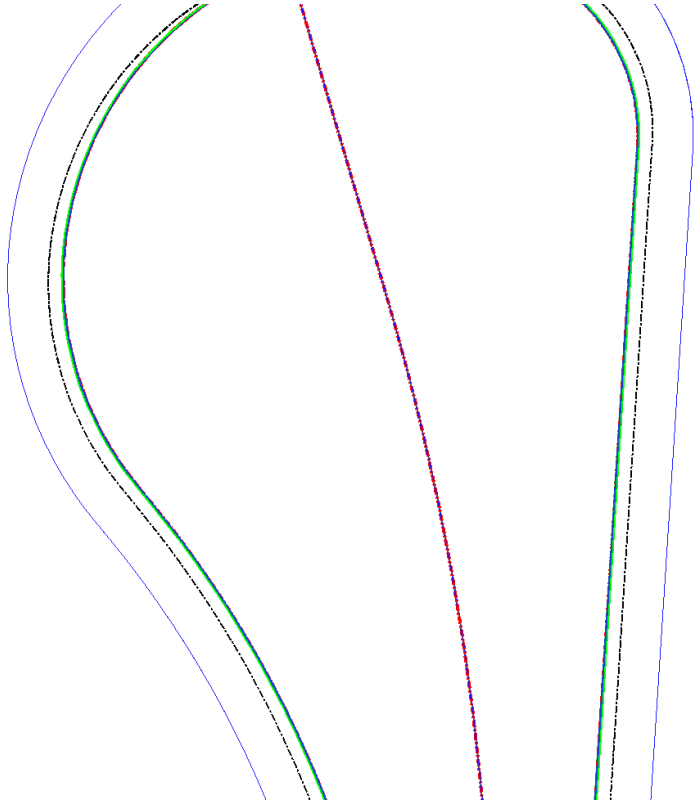

Udlæsning af punkter – Station Base Report

- Cant
- Civil Terrain
- CivilGeometry
- CivilSurvey
- CorridorModeling
- Evaluation
- LegalDescription
- MapCheck
- Milling
- Stakeout
- StationOffset
 - CivilToolsStationOffset.xml
 - CivilToolsStationOffsetExtended.xml
 - ProfileExistingProposedElevation.xml
 - ProfileExistingProposedElevationExtended.xml
 - ProfileStationElevation.xml
 - ProfileStationElevationASCII.xml
 - ProfileStationOffsetElevationASCII.xml
 - ProfileStationOffsetElevationASCII.xml
 - StationBaseCompare.xml
 - StationBaseCoordinates.xml
 - StationBaseCrossSlope.xml
 - StationBaseSimplifiedCrossSlope.xml
 - StationBaseSingle.xml
 - StationBaseVerticalClearance.xml
 - StationBaseWGrades.xml
 - StationOffset.xml
 - StationOffsetAlongSingleAlignment.xml
 - StationOffsetAlongSingleAlignmentExistGround.xml
 - StationOffsetAlongSingleAlignmentWRadius.xml
 - StationOffsetElevationFeature.xml
 - StationOffsetNorthingEasting.xml
 - StationOffsetNorthingEastingElevationFeature.xml
 - StationOffsetWithVersine.xml
 - StationOffsetWSmoothingRadius.xml
 - TransverseFeature.xml
 - VerticalFace.xml
- Superelevation
- TemplateLibrary
- Turnouts
- Tools
- Reports
 - GEOP_StationOffsetAfsaetning.xml

GEOP Station Offset Northing Easting Elevation Feature Report

Report Created: 2. november 2022
Time: 14:41:10

Project: Model-1
Description:
Baseline Alignment: Kristinelundsvej CL 3D
File Name: \\hvmmf01\sag\2021\2109902\105-Maskinstyring\01-Belægning-Bygning\00-Old\3D_vej_261021_UTM_2109902 - cni.dgn
Last Revised: 10-4-2022 13:01:04
Input Grid Factor: Note: All units in this report are in meters unless specified otherwise.

Point Type	Point Name	Feature	Northing	Easting	Elevation	Station	Offset
6	1	3000	6184981.955	547516.244	55.486	9.000	3.398
6	2	3000	6184986.084	547514.634	55.658	12.000	3.550
6	3	3000	6184988.697	547513.160	55.789	15.000	3.550
6	4	3000	6184991.310	547511.686	55.895	18.000	3.550
6	5	3000	6184993.998	547510.345	56.023	21.000	3.550
6	6	3000	6184995.044	547510.358	56.041	24.000	3.550
6	7	3000	6184998.044	547510.395	56.082	27.000	3.550
6	8	3000	6185001.044	547510.432	56.112	30.000	3.550
6	9	3000	6185004.044	547510.470	56.142	33.000	3.550
6	10	3000	6185007.043	547510.507	56.172	36.000	3.550
6	11	3000	6185010.043	547510.544	56.202	39.000	3.550
6	12	3000	6185013.043	547510.581	56.232	42.000	3.550
6	13	3000	6185016.043	547510.618	56.262	45.000	3.550
6	14	3000	6185018.855	547510.696	56.292	48.000	3.550
6	15	3000	6185021.849	547510.890	56.322	51.000	3.550
6	16	3000	6185024.843	547511.083	56.352	54.000	3.550
6	17	3000	6185027.836	547511.277	56.382	57.000	3.550
6	18	3000	6185030.830	547511.471	56.412	60.000	3.550

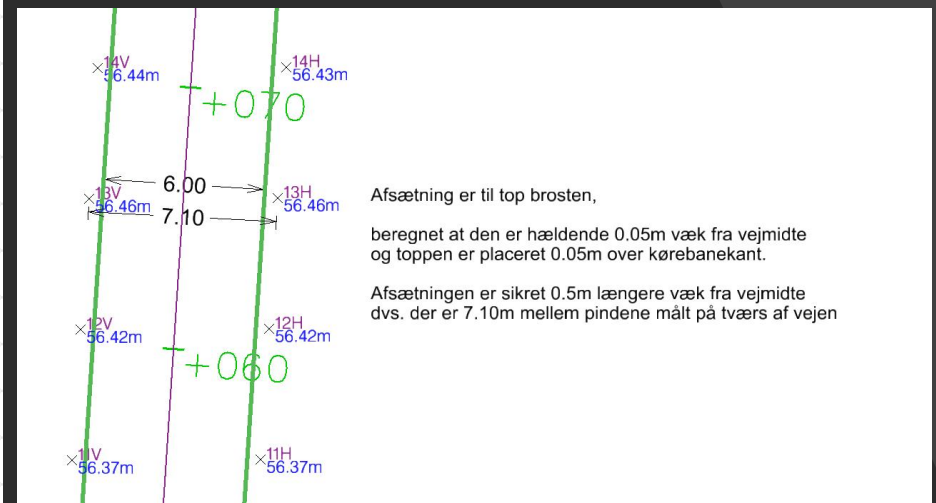
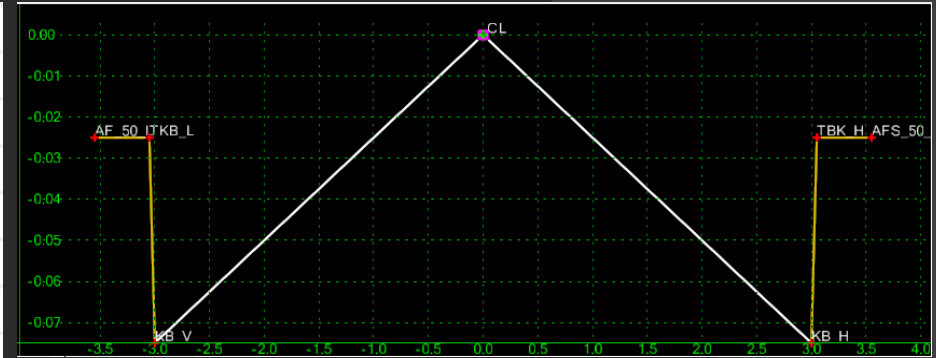

Ting at Huske

Oprettelse af
korridor

Terræn i 3D

Alignment i 2D

Korridor i 2D

- Project Explorer
- 04V
 - 05H
 - 05V
 - 06H
 - 06V
 - 07H
 - 07V
 - 08H
 - 08V
 - 09H
 - 09V
 - 10H
 - 10V
 - 11H
 - 11V
 - 12H
 - 12V
 - 13H
 - 13V
 - 14H
 - 14V
 - 15H
 - 15V
 - 16H
 - 16V
 - 17H
 - 17V
 - 18H
 - 18V
 - 19H
 - 19V
 - 20H
 - 20V
 - 21H
 - 21V
 - 22H
 - 22V
 - 23H
 - 23V
 - 24H
 - 24V
 - 25H
 - 25V
 - 26H
 - 26V
 - 27H
 - 27V
 - 28H
 - 272-VB07
 - 272-VB08
 - 272-VB09
 - 272-VB10
 - Job Site - Kristinelundsvej
 - Designs
 - Work Orders
 - Machines
 - Imported Files
 - 2D_vej_261021_UTM_210...
 - 2109902_Afs_kantsten_NE...

Properties

Point (1)

Point Information

Point ID: 02H

Selection sets:

Feature code: 3000.0

Description 1:

Description 2:

Include in surf: Yes

Layer

Layer: Points

Label Visibility

Show label: By view filter

Show feature c: By view filter

Show elevation: By view filter

Grid Coordinates - UTM 32 + DVR

Easting: 547515.805

Northing: 6184984.011

Elevation: 55.541

Local Coordinates - ETRS89

Latitude: N55°48'29.2249

Longitude: 09°45'29.23376

Height: 95.182

Global Coordinates - ETRF 1989 at

Latitude: N55°48'29.2249

Longitude: 09°45'29.23376

Height: 95.182

Property

Import file: 2109902_Afs_kants

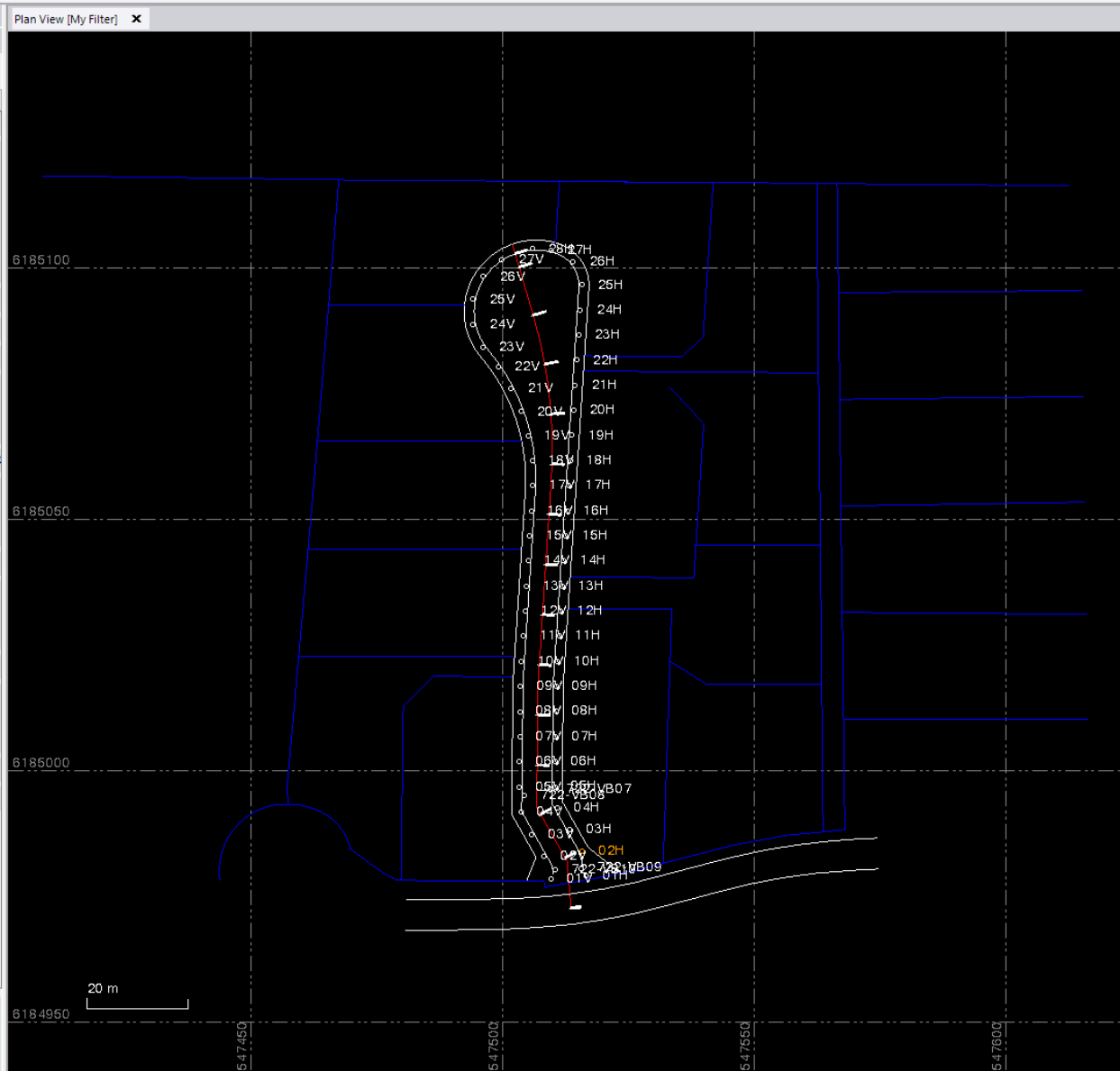

Job Site Design Manager

Name

Design name: Afs Kantsten

Version: V00 (modified)

Model

Type: None

Last update: <Not Available>

Edit... Resolve...

Setting Out Points

Last update: 02-11-2022 14:56:50

Number of points: 59

Select +/- Resolve...

Design Map

Last update: 02-11-2022 14:57:00

Number of objects: 238

Select +/- Resolve...

Controllers

Name	Software Version
Site Controllers	
PC	3.5
Simulator	3.74

Reassign...

External Services

Synchronize with Business Data Center via Office Synchronizer

Close

Afsætning i marken med Totalstation



Åbn sted

Sted:

Arbejdsordre:

Vejledning:

**Data til brug for afsætning af brosten.
Afsætning er regnet til top og bagkant brosten**

Design:

